

28330 3" Offset Wall Flange Aluminum Magnesium 1-1/2" IPS (1.94" ID)

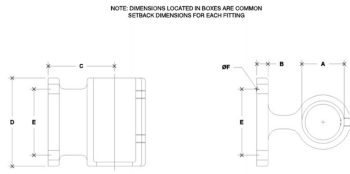
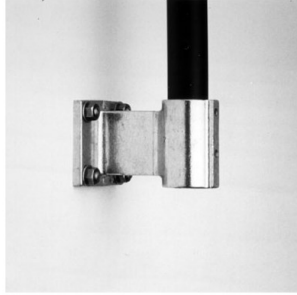

#54-3 Offset Wall Flange (3")

SCALE: 100%

PIPE SIZE	ENGLISH UNITS (Inches)							PIPE SIZE	METRIC UNITS (mm)						
	A	B	C	D	E	F	G		A	B	C	D	E	F	G
3"	1.315	1.315	1.315	1.315	1.315	1.315	1.315	33.0	33.0	33.0	33.0	33.0	33.0	33.0	33.0

[Click here for chart](#)

BUYRAILINGS
ARCHITECTURAL AND INDUSTRIAL RAILINGS

2" IPS
Schedule 40 2.375" O.D. 0.156" Wall
Schedule 80 2.375" O.D. 0.188" Wall
Schedule 160 2.375" O.D. 0.219" Wall

1 1/2" IPS
Schedule 40 1.915" O.D. 0.141" Wall
Schedule 80 1.915" O.D. 0.167" Wall
Schedule 160 1.915" O.D. 0.193" Wall

1" IPS
Schedule 40 1.315" O.D. 0.113" Wall
Schedule 80 1.315" O.D. 0.139" Wall
Schedule 160 1.315" O.D. 0.165" Wall

3/4" IPS
Schedule 40 1.063" O.D. 0.113" Wall
Schedule 80 1.063" O.D. 0.139" Wall
Schedule 160 1.063" O.D. 0.165" Wall

1/2" IPS
Schedule 40 0.875" O.D. 0.113" Wall
Schedule 80 0.875" O.D. 0.139" Wall
Schedule 160 0.875" O.D. 0.165" Wall