

**939TD** Top Rail Level End Bracket - Dark Bronze

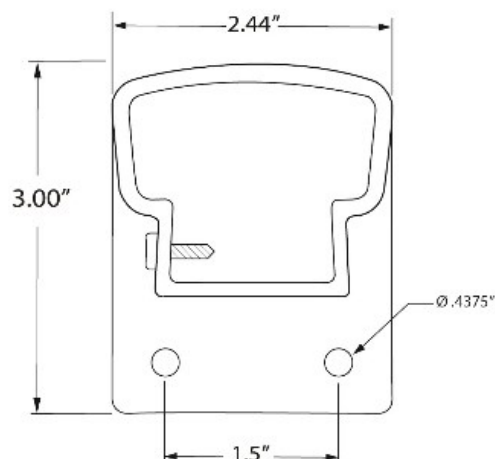

This Top Post End Bracket is made of cast aluminum and is in a dark bronze painted finish. It is designed to mount towards the top of our 9000/36/F and 9000/42/F receiver posts and will hold the top rails of our level picket rail panels 3642L.

Mount the bracket on the post using our 310-9 screws (sold separately - see related items).

Connect the panels to the brackets using our 912-9 binder bolts (sold separately - see related items).

Consult local building code for specific requirements in your area.

Call customer service for specific project take-offs and lead time information. Select items are in stock and can ship in 24-48 hours.