

QS-60 M12 - Fisher Highbond Anchor 316 Stainless Steel Length 6-3/8"

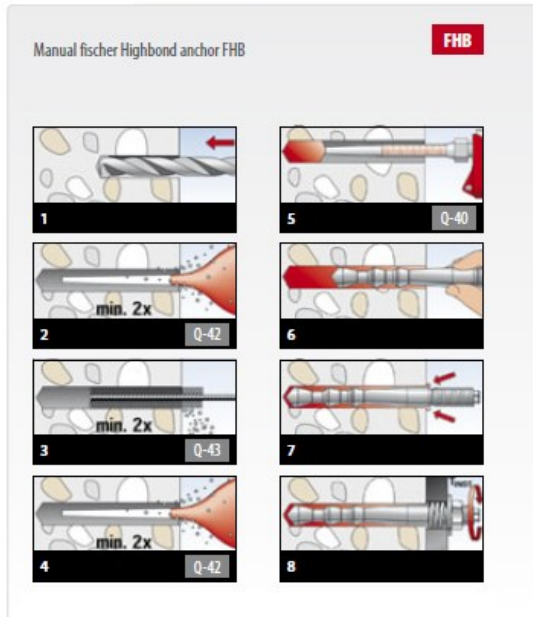

Approved for: Cracked and non-cracked concrete C20/25 to C50/60

Also suitable for: Concrete C12/15 For fixing of: Steel constructions, Railings, Staircases, Gates, Facades, Window elements or Stand-off installations.

- Highest loads due to greater anchorage depth.
- Push-through installation by using a push-through element (when using Injection mortar Q40).

QS-60 Made of stainless steel of the corrosion resistance class III e.g. A4 for outdoor use and in damp conditions. Highly corrosion-resistant steel of the corrosion resistance class IV e.g. 1.4529 for applications in aggressive atmospheres (e.g. tunnels, swimming baths).