

**QS-32 M12 - Fisher Highbond Anchor 316 Stainless Steel Length 4-5/8"**

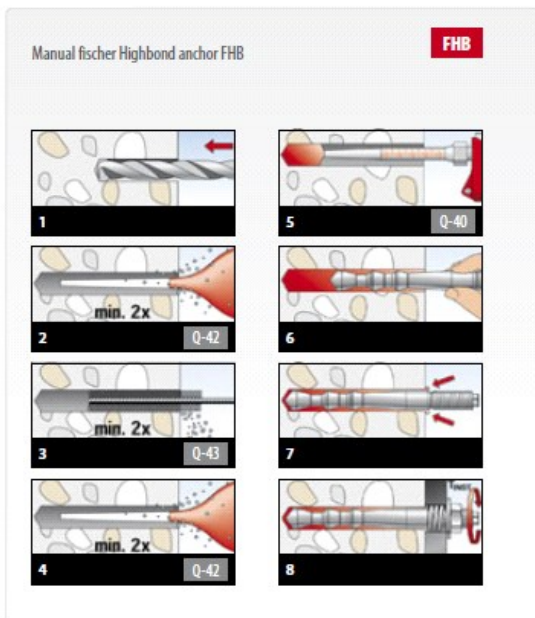

Approved for: Cracked and non-cracked concrete C20/25 to C50/60

Also suitable for: Concrete C12/15 For fixing of: Steel constructions, Railings, Staircases, Gates, Facades, Window elements or Stand-off installations.

Reduced anchorage depth for use in thin building components, therefore reduced drilling effort.

Suitable for pre-positioned and push-through installation.

QS-32 Made of stainless steel of the corrosion resistance class III e.g. A4 for outdoor use and in damp conditions. Highly corrosion-resistant steel of the corrosion resistance class IV e.g. 1.4529 for applications in aggressive atmospheres (e.g. tunnels, swimming baths).