

06410 Adj. Tee or Cross Male Aluminum Magnesium 1" IPS (1.38" ID)

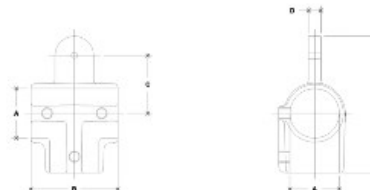

NOTE: DIMENSIONS LOCATED IN BOXES ARE COMMON
STRENGTH DIMENSIONS FOR EACH FITTING



#23M Adjustable Tee or Cross Male Body

SCALE: 1/8"=1"

PIPE SIZE	ENGLISH UNITS (Inches)						PIPE SIZE	METRIC UNITS (mm)							
	A	B	C	D	E	F		G	A	B	C	D	E	F	G
1"	1.50	3.50	2.50	1.50			1"	38	89	64	38				
1 1/4"	1.75	3.75	2.75	1.75			1 1/4"	45	95	70	45				
1 1/2"	1.88	3.88	2.88	1.88			1 1/2"	48	98	73	48				
2"	2.12	4.12	3.12	2.12			2"	54	104	79	54				
2 1/2"	2.37	4.37	3.37	2.37			2 1/2"	60	110	85	60				

[Click here for chart](#)

BUYRAILINGS
ARCHITECTURAL AND INDUSTRIAL RAILINGS

2" IPS
2.315" Outside O.D.
Schedule 40 2.287" I.D. 0.154" Wall
Schedule 80 1.989" I.D. 0.218" Wall

1 1/2" IPS
1.625" Outside O.D.
Schedule 40 1.597" I.D. 0.140" Wall
Schedule 80 1.399" I.D. 0.200" Wall

1 1/4" IPS
1.375" Outside O.D.
Schedule 40 1.347" I.D. 0.140" Wall
Schedule 80 1.149" I.D. 0.191" Wall

1" IPS
1.315" Outside O.D.
Schedule 40 1.287" I.D. 0.154" Wall
Schedule 80 0.989" I.D. 0.118" Wall

3/4" IPS
0.875" Outside O.D.
Schedule 40 0.847" I.D. 0.110" Wall
Schedule 80 0.749" I.D. 0.154" Wall