

**07080 Angle Tee (45°) Aluminum Magnesium 1-1/4" IPS (1.72" ID)**

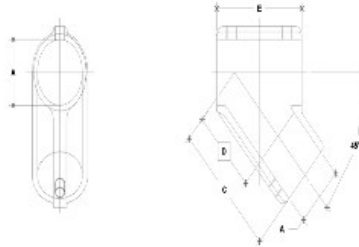

NOTE: DIMENSIONS LOCATED IN BOXES ARE COMMON  
DIMENSIONS (AS FIFER EACH FITTING)



**#6 Angle Tee (45°)**

CLASS: 141 T

ENGLISH UNITS (inches)							METRIC UNITS (mm)							
PW6 SIZE	A	B	C	D	E	F	PW6 SIZE	A	B	C	D	E	F	D
1 1/2"	1.75	4.12	2.51	2.26			44	105	67	58				
1 1/4"	1.68	3.91	2.35	2.16			42	100	61	55				

[Click here for chart](#)

**BUYRAILINGS**  
ARCHITECTURAL AND INDUSTRIAL RAILINGS

2" IPS  
2.375" Outer O.D.  
Schedule 40 2.381" I.D. 0.140" Wall  
Schedule 80 1.937" I.D. 0.218" Wall

1.5" IPS  
1.937" Outer O.D.  
Schedule 40 1.943" I.D. 0.140" Wall  
Schedule 80 1.593" I.D. 0.257" Wall

1.25" IPS  
1.687" Outer O.D.  
Schedule 40 1.693" I.D. 0.140" Wall  
Schedule 80 1.243" I.D. 0.181" Wall

1" IPS  
1.312" Outer O.D.  
Schedule 40 1.318" I.D. 0.140" Wall  
Schedule 80 0.967" I.D. 0.179" Wall

3/4" IPS  
1.062" Outer O.D.  
Schedule 40 1.068" I.D. 0.140" Wall  
Schedule 80 0.717" I.D. 0.154" Wall

1/2" IPS  
0.812" Outer O.D.  
Schedule 40 0.818" I.D. 0.140" Wall  
Schedule 80 0.467" I.D. 0.154" Wall