

08080 Angle Tee (45°) Aluminum Magnesium 1-1/2" IPS (1.94" ID)

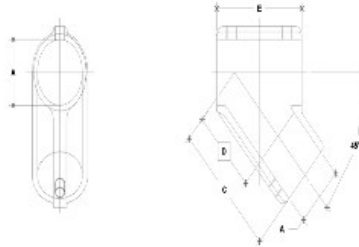

NOTE: DIMENSIONS LOCATED IN BOXES ARE COMMON BETWEEN COMING SIZES FOR EACH FITTING



#6 Angle Tee (45°)

CLASS: 141 T

ENGLISH UNITS (inches)							METRIC UNITS (mm)							
PW6 SIZE	A	B	C	D	E	F	PW6 SIZE	A	B	C	D	E	F	D
1 1/2"	1.75	4.0	2.5	2.0			45	100	100	64	51			
1 1/4"	1.63	3.75	2.38	1.88			42	95	95	61	49			

[Click here for chart](#)

BUYRAILINGS
ARCHITECTURAL AND INDUSTRIAL RAILINGS

2 1/2" IPS
Schedule 40 2.375" O.D. 0.188" Wall
Schedule 80 2.375" O.D. 0.219" Wall

2" IPS
Schedule 40 2.075" O.D. 0.188" Wall
Schedule 80 2.075" O.D. 0.219" Wall

1 1/2" IPS
Schedule 40 1.915" O.D. 0.188" Wall
Schedule 80 1.915" O.D. 0.219" Wall

1 1/4" IPS
Schedule 40 1.815" O.D. 0.188" Wall
Schedule 80 1.815" O.D. 0.219" Wall

1 1/8" IPS
Schedule 40 1.715" O.D. 0.188" Wall
Schedule 80 1.715" O.D. 0.219" Wall

1 1/2" IPS
Schedule 40 2.375" O.D. 0.188" Wall
Schedule 80 2.375" O.D. 0.219" Wall

1 1/4" IPS
Schedule 40 2.075" O.D. 0.188" Wall
Schedule 80 2.075" O.D. 0.219" Wall

1 1/8" IPS
Schedule 40 1.715" O.D. 0.188" Wall
Schedule 80 1.715" O.D. 0.219" Wall