

08070 Tee Side Rib Aluminum Magnesium 1-1/2" IPS (1.94" ID)

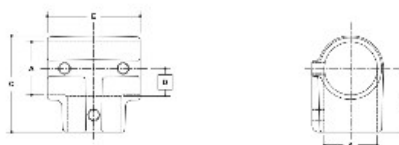

NOTE: DIMING ON 5 LOCATED IN EDGES ARE COMMON
DIMS: A + DIM: 5/16" 1/8" FOR D/C 1/16" 1/8"



#5SR Tee Side Rib

SCALE: 1/4"=1'

PIPE SIZE	DIMENSIONS (inches)							PIPE SIZE	DIMENSIONS (mm)						
	A	B	C	D	E	F	G		A	B	C	D	E	F	G
2"	7.40	5.73	4.14	1.28	5.84			188	146	106	33	149			
1 1/2"	4.82	3.71	2.65	0.85	4.24			122	94	67	22	108			

[Click here for chart](#)

BUYRAILINGS
ARCHITECTURAL AND INDUSTRIAL RAILINGS

2" IPS
2.315" Outside O.D.
Schedule 40 2.307" I.D. 0.154" Wall
Schedule 80 1.929" I.D. 0.218" Wall

1 1/2" IPS
1.915" Outside O.D.
Schedule 40 1.897" I.D. 0.140" Wall
Schedule 80 1.529" I.D. 0.202" Wall

1" IPS
1.315" Outside O.D.
Schedule 40 1.297" I.D. 0.140" Wall
Schedule 80 1.079" I.D. 0.191" Wall

3/4" IPS
1.060" Outside O.D.
Schedule 40 1.042" I.D. 0.110" Wall
Schedule 80 0.814" I.D. 0.154" Wall

1/2" IPS
0.815" Outside O.D.
Schedule 40 0.797" I.D. 0.110" Wall
Schedule 80 0.614" I.D. 0.154" Wall