

**08110 5EXT-8 Extended Barrel Tee Aluminum Magnesium Pipe Size-1-1/2" IPS (1.94" ID)**

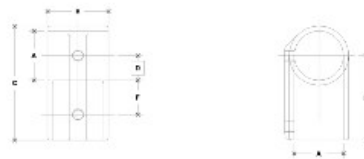

NOTE: DIMENSIONS LOCATED IN BOLD ARE COMMON SETBACK DIMENSIONS FOR EACH FITTING



**#5EXT Extended Barrel Tee**

PIPE SIZE	DIMENSIONS (INCHES)						DIMENSIONS (MILLIMETERS)					
	A	D	G	E	F	G	A	D	G	E	F	G
1 1/2"	1.92	3.38	4.13	1.69	2.63	1.31	49.02	85.92	105.92	42.92	66.78	33.28

[Click here for chart](#)

**BUYRAILINGS**  
ARCHITECTURAL AND INDUSTRIAL RAILINGS

Chart showing various pipe sizes and their dimensions for different fittings. The chart includes the following information:

- 2" IPS**: 2 3/8" OD, 2.00" ID, Schedule 40, 2.375" ID, 2.125" Wall
- 1 1/2" IPS**: 1 9/8" OD, 1.625" ID, Schedule 40, 1.875" ID, 2.250" Wall
- 1 1/4" IPS**: 1 5/8" OD, 1.375" ID, Schedule 40, 1.625" ID, 2.187" ID, 2.187" Wall
- 1 1/8" IPS**: 1 3/8" OD, 1.125" ID, Schedule 40, 1.375" ID, 2.125" Wall
- 1" IPS**: 1 1/8" OD, 1.000" ID, Schedule 40, 1.125" ID, 2.125" Wall
- 3/4" IPS**: 1 1/8" OD, 7/8" ID, Schedule 40, 1.000" ID, 2.125" Wall