

09530 Nu-Rail Adj. Swivel Aluminum Magnesium 2" IPS (2.41" ID)

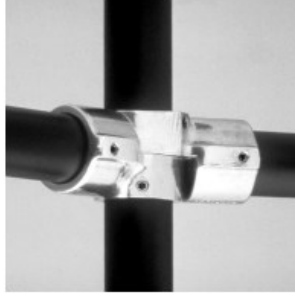

NOTE: DIMENSIONS LOCKED TO FIT 2" IPS PIPE
ALUMINUM MAGNESIUM 2" IPS

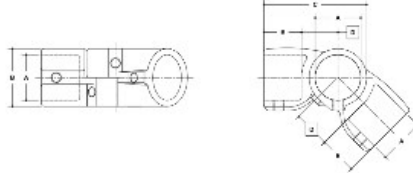

#30C Nu-Rail Adjustable Swivel

| SWITCH SYSTEM | | | | | | | MULTI SYSTEM | | | | | | | |
|---------------|------|------|------|------|------|------|--------------|----|-----|-----|-----|-----|---|---|
| FINISH | A | B | C | D | E | F | FINISH | A | B | C | D | E | F | G |
| 2" | 3.50 | 2.80 | 4.31 | 1.75 | 1.75 | 1.75 | 2" | 13 | 75 | 28 | 44 | 44 | | |
| 1.5" | 2.51 | 2.06 | 3.12 | 1.33 | 1.33 | 1.33 | 1.5" | 45 | 102 | 111 | 109 | 111 | | |
| 1.25" | 1.91 | 1.71 | 2.60 | 1.14 | 1.14 | 1.14 | 1.25" | 47 | 74 | 91 | 74 | 74 | | |
| 1" | 1.51 | 1.28 | 2.15 | 0.92 | 0.92 | 0.92 | 1" | 34 | 44 | 64 | 55 | 55 | | |
| 0.75" | 1.01 | 0.92 | 1.61 | 0.75 | 0.75 | 0.75 | 0.75" | 27 | 34 | 44 | 35 | 35 | | |

[Click here for chart](#)

BUYRAILINGS
ARCHITECTURAL AND INDUSTRIAL RAILINGS

2" IPS
2.375" Outer O.D.
Schedule 40 2.375" I.D. 0.148" Wall
Schedule 80 1.937" I.D. 0.218" Wall

1.5" IPS
1.312" Outer O.D.
Schedule 40 1.312" I.D. 0.148" Wall
Schedule 80 1.062" I.D. 0.257" Wall

1.25" IPS
1.187" Outer O.D.
Schedule 40 1.187" I.D. 0.148" Wall
Schedule 80 0.937" I.D. 0.187" Wall

1" IPS
0.937" Outer O.D.
Schedule 40 0.937" I.D. 0.148" Wall
Schedule 80 0.687" I.D. 0.177" Wall

0.75" IPS
0.718" Outer O.D.
Schedule 40 0.718" I.D. 0.148" Wall
Schedule 80 0.468" I.D. 0.154" Wall