

07530 Nu-Rail Adj. Swivel Aluminum Magnesium 1-1/4" IPS (1.72" ID)

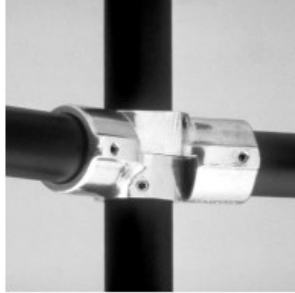

NOTE: DIMENSIONS LOCKED TO 1/16" UNLESS OTHERWISE SPECIFIED

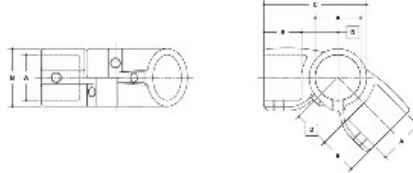

#30C Nu-Rail Adjustable Swivel

SWITCHES						MATERIALS					
FINISH	A	B	C	D	E	FINISH	A	B	C	D	E
2"	3.50	2.80	4.31	1.75	.75	2"	1.5	1.5	2.0	1.5	.75
2 1/2"	3.50	2.80	4.31	1.75	.75	2 1/2"	1.5	1.5	2.0	1.5	.75
3"	3.50	2.80	4.31	1.75	.75	3"	1.5	1.5	2.0	1.5	.75
3 1/2"	3.50	2.80	4.31	1.75	.75	3 1/2"	1.5	1.5	2.0	1.5	.75
4"	3.50	2.80	4.31	1.75	.75	4"	1.5	1.5	2.0	1.5	.75
4 1/2"	3.50	2.80	4.31	1.75	.75	4 1/2"	1.5	1.5	2.0	1.5	.75
5"	3.50	2.80	4.31	1.75	.75	5"	1.5	1.5	2.0	1.5	.75
5 1/2"	3.50	2.80	4.31	1.75	.75	5 1/2"	1.5	1.5	2.0	1.5	.75
6"	3.50	2.80	4.31	1.75	.75	6"	1.5	1.5	2.0	1.5	.75
6 1/2"	3.50	2.80	4.31	1.75	.75	6 1/2"	1.5	1.5	2.0	1.5	.75
7"	3.50	2.80	4.31	1.75	.75	7"	1.5	1.5	2.0	1.5	.75
7 1/2"	3.50	2.80	4.31	1.75	.75	7 1/2"	1.5	1.5	2.0	1.5	.75
8"	3.50	2.80	4.31	1.75	.75	8"	1.5	1.5	2.0	1.5	.75
8 1/2"	3.50	2.80	4.31	1.75	.75	8 1/2"	1.5	1.5	2.0	1.5	.75
9"	3.50	2.80	4.31	1.75	.75	9"	1.5	1.5	2.0	1.5	.75
9 1/2"	3.50	2.80	4.31	1.75	.75	9 1/2"	1.5	1.5	2.0	1.5	.75
10"	3.50	2.80	4.31	1.75	.75	10"	1.5	1.5	2.0	1.5	.75
10 1/2"	3.50	2.80	4.31	1.75	.75	10 1/2"	1.5	1.5	2.0	1.5	.75
11"	3.50	2.80	4.31	1.75	.75	11"	1.5	1.5	2.0	1.5	.75
11 1/2"	3.50	2.80	4.31	1.75	.75	11 1/2"	1.5	1.5	2.0	1.5	.75
12"	3.50	2.80	4.31	1.75	.75	12"	1.5	1.5	2.0	1.5	.75
12 1/2"	3.50	2.80	4.31	1.75	.75	12 1/2"	1.5	1.5	2.0	1.5	.75
13"	3.50	2.80	4.31	1.75	.75	13"	1.5	1.5	2.0	1.5	.75
13 1/2"	3.50	2.80	4.31	1.75	.75	13 1/2"	1.5	1.5	2.0	1.5	.75
14"	3.50	2.80	4.31	1.75	.75	14"	1.5	1.5	2.0	1.5	.75
14 1/2"	3.50	2.80	4.31	1.75	.75	14 1/2"	1.5	1.5	2.0	1.5	.75
15"	3.50	2.80	4.31	1.75	.75	15"	1.5	1.5	2.0	1.5	.75
15 1/2"	3.50	2.80	4.31	1.75	.75	15 1/2"	1.5	1.5	2.0	1.5	.75
16"	3.50	2.80	4.31	1.75	.75	16"	1.5	1.5	2.0	1.5	.75
16 1/2"	3.50	2.80	4.31	1.75	.75	16 1/2"	1.5	1.5	2.0	1.5	.75
17"	3.50	2.80	4.31	1.75	.75	17"	1.5	1.5	2.0	1.5	.75
17 1/2"	3.50	2.80	4.31	1.75	.75	17 1/2"	1.5	1.5	2.0	1.5	.75
18"	3.50	2.80	4.31	1.75	.75	18"	1.5	1.5	2.0	1.5	.75
18 1/2"	3.50	2.80	4.31	1.75	.75	18 1/2"	1.5	1.5	2.0	1.5	.75
19"	3.50	2.80	4.31	1.75	.75	19"	1.5	1.5	2.0	1.5	.75
19 1/2"	3.50	2.80	4.31	1.75	.75	19 1/2"	1.5	1.5	2.0	1.5	.75
20"	3.50	2.80	4.31	1.75	.75	20"	1.5	1.5	2.0	1.5	.75
20 1/2"	3.50	2.80	4.31	1.75	.75	20 1/2"	1.5	1.5	2.0	1.5	.75
21"	3.50	2.80	4.31	1.75	.75	21"	1.5	1.5	2.0	1.5	.75
21 1/2"	3.50	2.80	4.31	1.75	.75	21 1/2"	1.5	1.5	2.0	1.5	.75
22"	3.50	2.80	4.31	1.75	.75	22"	1.5	1.5	2.0	1.5	.75
22 1/2"	3.50	2.80	4.31	1.75	.75	22 1/2"	1.5	1.5	2.0	1.5	.75
23"	3.50	2.80	4.31	1.75	.75	23"	1.5	1.5	2.0	1.5	.75
23 1/2"	3.50	2.80	4.31	1.75	.75	23 1/2"	1.5	1.5	2.0	1.5	.75
24"	3.50	2.80	4.31	1.75	.75	24"	1.5	1.5	2.0	1.5	.75
24 1/2"	3.50	2.80	4.31	1.75	.75	24 1/2"	1.5	1.5	2.0	1.5	.75
25"	3.50	2.80	4.31	1.75	.75	25"	1.5	1.5	2.0	1.5	.75
25 1/2"	3.50	2.80	4.31	1.75	.75	25 1/2"	1.5	1.5	2.0	1.5	.75
26"	3.50	2.80	4.31	1.75	.75	26"	1.5	1.5	2.0	1.5	.75
26 1/2"	3.50	2.80	4.31	1.75	.75	26 1/2"	1.5	1.5	2.0	1.5	.75
27"	3.50	2.80	4.31	1.75	.75	27"	1.5	1.5	2.0	1.5	.75
27 1/2"	3.50	2.80	4.31	1.75	.75	27 1/2"	1.5	1.5	2.0	1.5	.75
28"	3.50	2.80	4.31	1.75	.75	28"	1.5	1.5	2.0	1.5	.75
28 1/2"	3.50	2.80	4.31	1.75	.75	28 1/2"	1.5	1.5	2.0	1.5	.75
29"	3.50	2.80	4.31	1.75	.75	29"	1.5	1.5	2.0	1.5	.75
29 1/2"	3.50	2.80	4.31	1.75	.75	29 1/2"	1.5	1.5	2.0	1.5	.75
30"	3.50	2.80	4.31	1.75	.75	30"	1.5	1.5	2.0	1.5	.75
30 1/2"	3.50	2.80	4.31	1.75	.75	30 1/2"	1.5	1.5	2.0	1.5	.75
31"	3.50	2.80	4.31	1.75	.75	31"	1.5	1.5	2.0	1.5	.75
31 1/2"	3.50	2.80	4.31	1.75	.75	31 1/2"	1.5	1.5	2.0	1.5	.75
32"	3.50	2.80	4.31	1.75	.75	32"	1.5	1.5	2.0	1.5	.75
32 1/2"	3.50	2.80	4.31	1.75	.75	32 1/2"	1.5	1.5	2.0	1.5	.75
33"	3.50	2.80	4.31	1.75	.75	33"	1.5	1.5	2.0	1.5	.75
33 1/2"	3.50	2.80	4.31	1.75	.75	33 1/2"	1.5	1.5	2.0	1.5	.75
34"	3.50	2.80	4.31	1.75	.75	34"	1.5	1.5	2.0	1.5	.75
34 1/2"	3.50	2.80	4.31	1.75	.75	34 1/2"	1.5	1.5	2.0	1.5	.75
35"	3.50	2.80	4.31	1.75	.75	35"	1.5	1.5	2.0	1.5	.75
35 1/2"	3.50	2.80	4.31	1.75	.75	35 1/2"	1.5	1.5	2.0	1.5	.75
36"	3.50	2.80	4.31	1.75	.75	36"	1.5	1.5	2.0	1.5	.75
36 1/2"	3.50	2.80	4.31	1.75	.75	36 1/2"	1.5	1.5	2.0	1.5	.75
37"	3.50	2.80	4.31	1.75	.75	37"	1.5	1.5	2.0	1.5	.75
37 1/2"	3.50	2.80	4.31	1.75	.75	37 1/2"	1.5	1.5	2.0	1.5	.75
38"	3.50	2.80	4.31	1.75	.75	38"	1.5	1.5	2.0	1.5	.75
38 1/2"	3.50	2.80	4.31	1.75	.75	38 1/2"	1.5	1.5	2.0	1.5	.75
39"	3.50	2.80	4.31	1.75	.75	39"	1.5	1.5	2.0	1.5	.75
39 1/2"	3.50	2.80	4.31	1.75	.75	39 1/2"	1.5	1.5	2.0	1.5	.75
40"	3.50	2.80	4.31	1.75	.75	40"	1.5	1.5	2.0	1.5	.75
40 1/2"	3.50	2.80	4.31	1.75	.75	40 1/2"	1.5	1.5	2.0	1.5	.75
41"	3.50	2.80	4.31	1.75	.75	41"	1.5	1.5	2.0	1.5	.75
41 1/2"	3.50	2.80	4.31	1.75	.75	41 1/2"	1.5	1.5	2.0	1.5	.75
42"	3.50	2.80	4.31	1.75	.75	42"	1.5	1.5	2.0	1.5	.75
42 1/2"	3.50	2.80	4.31	1.75	.75	42 1/2"	1.5	1.5	2.0	1.5	.75
43"	3.50	2.80	4.31	1.75	.75	43"	1.5	1.5	2.0	1.5	.75
43 1/2"	3.50	2.80	4.31	1.75	.75	43 1/2"	1.5	1.5	2.0	1.5	.75
44"	3.50	2.80	4.31	1.75	.75	44"	1.5	1.5	2.0	1.5	.75
44 1/2"	3.50	2.80	4.31	1.75	.75	44 1/2"	1.5	1.5	2.0	1.5	.75
45"	3.50	2.80	4.31	1.75	.75	45"	1.5	1.5	2.0	1.5	.75
45 1/2"	3.50	2.80	4.31	1.75	.75	45 1/2"	1.5	1.5	2.0	1.5	.75
46"	3.50	2.80	4.31	1.75	.75	46"	1.5	1.5	2.0	1.5	.75
46 1/2"	3.50	2.80	4.31	1.75	.75	46 1/2"	1.5	1.5	2.0	1.5	.75
47"	3.50	2.80	4.31	1.75	.75	47"	1.5	1.5	2.0	1.5	.75
47 1/2"	3.50	2.80	4.31	1.75	.75	47 1/2"	1.5	1.5	2.0	1.5	.75
48"	3.50	2.80	4.31	1.75	.75	48"	1.5	1.5	2.0	1.5	.75
48 1/2"	3.50	2.80	4.31	1.75	.75	48 1/2"	1.5	1.5	2.0	1.5	.75
49"	3.50	2.80	4.31	1.75	.75	49"	1.5	1.5	2.0	1.5	.75
49 1/2"	3.50	2.80	4.31	1.75	.75	49 1/2"	1.5	1.5	2.0	1.5	.75
50"	3.50	2.80	4.31	1.75	.75	50"	1.5	1.5	2.0	1.5	.75

Click here for chart

BUYRAILINGS
ARCHITECTURAL & INDUSTRIAL RAILINGS

2" IPS
Schedule 40 2.875" O.D., 0.188" Wall
Schedule 80 1.875" I.D., 0.219" Wall

2 1/2" IPS
Schedule 40 3.500" O