

08530 Nu-Rail Adj. Swivel Aluminum Magnesium 1-1/2" IPS (1.94" ID)

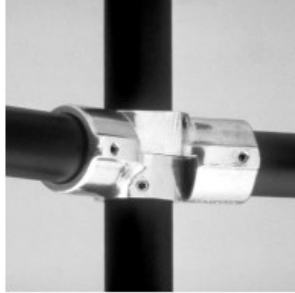

NOTE: DIMENSIONS LOCKED TO FIT 1.94" I.D. PIPE
ALUMINUM MAGNESIUM 6061 T6

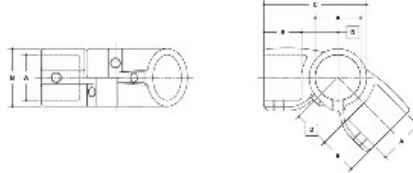

#30C Nu-Rail Adjustable Swivel

SWIVEL SYSTEMS						SWIVEL SYSTEMS					
FINISH	A	B	C	D	E	FINISH	A	B	C	D	E
30	3.50	2.80	4.31	1.75	1.75	30	3.50	2.80	4.31	1.75	1.75
30C	3.50	2.80	4.31	1.75	1.75	30C	3.50	2.80	4.31	1.75	1.75
30E	3.50	2.80	4.31	1.75	1.75	30E	3.50	2.80	4.31	1.75	1.75
30F	3.50	2.80	4.31	1.75	1.75	30F	3.50	2.80	4.31	1.75	1.75
30G	3.50	2.80	4.31	1.75	1.75	30G	3.50	2.80	4.31	1.75	1.75
30H	3.50	2.80	4.31	1.75	1.75	30H	3.50	2.80	4.31	1.75	1.75

[Click here for chart](#)

BUYRAILINGS
ARCHITECTURAL AND INDUSTRIAL RAILINGS

2 1/2" IPS
Schedule 40 2.315" I.D., 0.188" Wall
Schedule 80 1.937" I.D., 0.219" Wall

1 1/2" IPS
Schedule 40 1.315" I.D., 0.188" Wall
Schedule 80 1.037" I.D., 0.250" Wall

1" IPS
Schedule 40 0.915" I.D., 0.188" Wall
Schedule 80 0.637" I.D., 0.188" Wall

3/4" IPS
Schedule 40 0.615" I.D., 0.188" Wall
Schedule 80 0.337" I.D., 0.188" Wall