

**07690 Gate Hinge Female Extrusion Aluminum Magnesium 1-1/4" IPS (1.72" ID)**

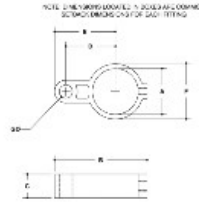

**#781 Extruded Gate Hinge Female Body**  
SCALE: 1/8"=1"

EXTRUSION DIMENSIONS										FLANGE DIMENSIONS									
IPS	A	B	C	D	E	F	G	H	I	IPS	J	K	L	M	N	O	P	Q	R
1/2"	1.00	1.50	1.00	1.00	1.00	1.00	1.00	1.00	1.00	1.00	1.00	1.00	1.00	1.00	1.00	1.00	1.00	1.00	1.00
3/4"	1.50	2.25	1.50	1.50	1.50	1.50	1.50	1.50	1.50	1.50	1.50	1.50	1.50	1.50	1.50	1.50	1.50	1.50	1.50
1"	2.00	3.00	2.00	2.00	2.00	2.00	2.00	2.00	2.00	2.00	2.00	2.00	2.00	2.00	2.00	2.00	2.00	2.00	2.00
1 1/4"	2.50	3.75	2.50	2.50	2.50	2.50	2.50	2.50	2.50	2.50	2.50	2.50	2.50	2.50	2.50	2.50	2.50	2.50	2.50
1 1/2"	3.00	4.50	3.00	3.00	3.00	3.00	3.00	3.00	3.00	3.00	3.00	3.00	3.00	3.00	3.00	3.00	3.00	3.00	3.00
2"	4.00	6.00	4.00	4.00	4.00	4.00	4.00	4.00	4.00	4.00	4.00	4.00	4.00	4.00	4.00	4.00	4.00	4.00	4.00
2 1/2"	5.00	7.50	5.00	5.00	5.00	5.00	5.00	5.00	5.00	5.00	5.00	5.00	5.00	5.00	5.00	5.00	5.00	5.00	5.00
3"	6.00	9.00	6.00	6.00	6.00	6.00	6.00	6.00	6.00	6.00	6.00	6.00	6.00	6.00	6.00	6.00	6.00	6.00	6.00

[Click here for chart](#)

**BUYRAILINGS**  
EXTRUSIONS AND FINISHES AVAILABLE

2 1/2" IPS  
2 1/2" SCH 40 O.D.  
Schedule 40 2 1/2" I.D., 0.188" Wall  
Schedule 40 1 1/2" I.D., 0.218" Wall

1 1/2" IPS  
1 1/2" SCH 40 O.D.  
Schedule 40 1 1/2" I.D., 0.188" Wall  
Schedule 40 1 1/2" I.D., 0.250" Wall

1 1/4" IPS  
1 1/4" SCH 40 O.D.  
Schedule 40 1 1/4" I.D., 0.188" Wall  
Schedule 40 1 1/4" I.D., 0.188" Wall

1" IPS  
1" SCH 40 O.D.  
Schedule 40 1" I.D., 0.188" Wall  
Schedule 40 1" I.D., 0.188" Wall

3/4" IPS  
3/4" SCH 40 O.D.  
Schedule 40 3/4" I.D., 0.188" Wall  
Schedule 40 3/4" I.D., 0.188" Wall

1/2" IPS  
1/2" SCH 40 O.D.  
Schedule 40 1/2" I.D., 0.188" Wall  
Schedule 40 1/2" I.D., 0.188" Wall