

08280 Adj. Elbow or Tee Male Body Aluminum Magnesium 1-1/2" IPS (1.94" ID)

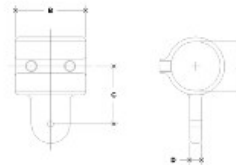

NOTE: DIMENSIONS LOCATED IN DASHES ARE COMMON
STANDARD DIMENSIONS FOR OTHER FITTINGS



#17M Adjustable Elbow or Tee Male Body

SCALE: 1/4"=1"

PIPE SIZE	ENGLISH UNITS (Inches)								METRIC UNITS (mm)								
	A	B	C	D	E	F	G	H	I	J	K	L	M	N	O	P	Q
1/2"	1.31	2.15	2.25	3.42													
3/4"	1.42	2.35	2.35	3.42													
1"	1.53	2.60	2.42	3.42													
1 1/2"	1.61	2.60	2.39	3.42													

[Click here for chart](#)

BUYRAILINGS
Architectural and Industrial Railings

2" IPS
2.315" Outside O.D.
Schedule 40 2.307" I.D. 0.154" Wall
Schedule 80 1.929" I.D. 0.218" Wall

1.5" IPS
1.915" Outside O.D.
Schedule 40 1.897" I.D. 0.142" Wall
Schedule 80 1.529" I.D. 0.207" Wall

1.25" IPS
1.615" Outside O.D.
Schedule 40 1.597" I.D. 0.142" Wall
Schedule 80 1.229" I.D. 0.197" Wall

1" IPS
1.315" Outside O.D.
Schedule 40 1.297" I.D. 0.142" Wall
Schedule 80 0.929" I.D. 0.197" Wall

3/4" IPS
1.115" Outside O.D.
Schedule 40 1.097" I.D. 0.142" Wall
Schedule 80 0.729" I.D. 0.197" Wall