

**06280 Adj. Elbow or Tee Male Body Aluminum Magnesium 1" IPS (1.38" ID)**

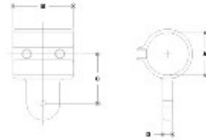

WITH DIMENSIONS LISTED IN MILLIMETERS  
APPROXIMATE DIMENSIONS ONLY



**#17M Adjustable Elbow or Tee Male Body**  
SCALE: 1:1

PIPE INCH	DIMENSIONS (Inches)								PIPE INCH	DIMENSIONS (mm)							
	A	B	C	D	E	F	G	H		A	B	C	D	E	F	G	H
1/2"	1.12	1.12	1.12	1.12	1.12	1.12	1.12	1.12	1.12	1.12	1.12	1.12	1.12	1.12	1.12	1.12	1.12
3/4"	1.12	1.12	1.12	1.12	1.12	1.12	1.12	1.12	1.12	1.12	1.12	1.12	1.12	1.12	1.12	1.12	1.12
1"	1.12	1.12	1.12	1.12	1.12	1.12	1.12	1.12	1.12	1.12	1.12	1.12	1.12	1.12	1.12	1.12	1.12
1 1/4"	1.12	1.12	1.12	1.12	1.12	1.12	1.12	1.12	1.12	1.12	1.12	1.12	1.12	1.12	1.12	1.12	1.12
1 1/2"	1.12	1.12	1.12	1.12	1.12	1.12	1.12	1.12	1.12	1.12	1.12	1.12	1.12	1.12	1.12	1.12	1.12
2"	1.12	1.12	1.12	1.12	1.12	1.12	1.12	1.12	1.12	1.12	1.12	1.12	1.12	1.12	1.12	1.12	1.12

[Click here for chart](#)

**BUYRAILINGS**  
EQUIPMENT FOR RAILINGS

2 1/2" IPS  
Schedule 40 2.375" O.D., 0.188" Wall  
Schedule 80 1.875" I.D., 0.218" Wall

1 1/2" IPS  
Schedule 40 1.625" O.D., 0.188" Wall  
Schedule 80 1.125" I.D., 0.257" Wall

1" IPS  
Schedule 40 1.315" O.D., 0.188" Wall  
Schedule 80 0.815" I.D., 0.177" Wall

3/4" IPS  
Schedule 40 1.063" O.D., 0.188" Wall  
Schedule 80 0.563" I.D., 0.157" Wall