

**07090 Cross Aluminum Magnesium 1-1/4" IPS (1.72" ID)**

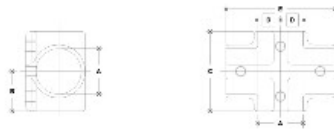

NOTE: DIMENSIONS LISTED IN INCHES UNLESS OTHERWISE SPECIFIED. DIMENSIONS FOR TYPICAL FITTINGS.



#7 Cross

PIPE SIZE	UNION END DIMENSIONS					FLANGE END DIMENSIONS				
	A	B	C	D	E	F	G	H	I	J
1/2"	1.12	1.12	1.12	1.12	1.12	1.12	1.12	1.12	1.12	1.12
3/4"	1.12	1.12	1.12	1.12	1.12	1.12	1.12	1.12	1.12	1.12
1"	1.12	1.12	1.12	1.12	1.12	1.12	1.12	1.12	1.12	1.12
1 1/4"	1.12	1.12	1.12	1.12	1.12	1.12	1.12	1.12	1.12	1.12
1 1/2"	1.12	1.12	1.12	1.12	1.12	1.12	1.12	1.12	1.12	1.12
2"	1.12	1.12	1.12	1.12	1.12	1.12	1.12	1.12	1.12	1.12

Click here for chart

**BUYRAILINGS**  
EQUIPMENT AND ACCESSORIES

2 1/2" IPS  
2 1/2" Sch 40 O.D.  
Schedule 40 2.375" I.D., 0.148" Wall  
Schedule 40 1.887" I.D., 0.218" Wall

1 1/2" IPS  
1 1/2" Sch 40 O.D.  
Schedule 40 1.625" I.D., 0.148" Wall  
Schedule 40 1.137" I.D., 0.257" Wall

1 1/4" IPS  
1 1/4" Sch 40 O.D.  
Schedule 40 1.387" I.D., 0.147" Wall  
Schedule 40 0.899" I.D., 0.181" Wall

1" IPS  
1" Sch 40 O.D.  
Schedule 40 0.887" I.D., 0.148" Wall  
Schedule 40 0.399" I.D., 0.178" Wall

3/4" IPS  
3/4" Sch 40 O.D.  
Schedule 40 0.687" I.D., 0.147" Wall  
Schedule 40 0.199" I.D., 0.158" Wall