

09350 Outside Corner Aluminum Magnesium 2" IPS (2.41" ID)

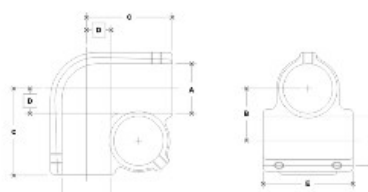

NOTE: DIMENSIONS & CENTER TO CENTER DISTANCE DIMENSIONS FOR EACH FITTING



#20 Outside Corner

SCALE: 1/4"=1"

| ENGLISH UNITS (inches) | | | | | | | | METRIC UNITS (mm) | | | | | | | |
|------------------------|------|------|------|------|------|------|------|-------------------|-------|-------|-------|-------|-------|-------|-------|
| PIPE SIZE | A | B | C | D | E | F | G | PIPE SIZE | A | B | C | D | E | F | G |
| 1 1/2" | 1.75 | 1.75 | 1.75 | 1.75 | 1.75 | 1.75 | 1.75 | 44.27 | 44.27 | 44.27 | 44.27 | 44.27 | 44.27 | 44.27 | 44.27 |
| 2" | 1.82 | 1.82 | 1.82 | 1.82 | 1.82 | 1.82 | 1.82 | 46.35 | 46.35 | 46.35 | 46.35 | 46.35 | 46.35 | 46.35 | 46.35 |
| 2 1/2" | 1.88 | 1.78 | 1.78 | 1.78 | 1.78 | 1.78 | 1.78 | 47.78 | 45.19 | 45.19 | 45.19 | 45.19 | 45.19 | 45.19 | 45.19 |
| 3" | 1.93 | 1.74 | 1.74 | 1.74 | 1.74 | 1.74 | 1.74 | 49.17 | 44.14 | 44.14 | 44.14 | 44.14 | 44.14 | 44.14 | 44.14 |
| 3 1/2" | 1.97 | 1.71 | 1.71 | 1.71 | 1.71 | 1.71 | 1.71 | 50.16 | 43.33 | 43.33 | 43.33 | 43.33 | 43.33 | 43.33 | 43.33 |

[Click here for chart](#)

BUYRAILINGS
ARCHITECTURAL AND INDUSTRIAL RAILINGS

2" IPS
2.319" Outside O.D.
Schedule 40 2.267" I.D. 0.154" Wall
Schedule 80 1.929" I.D. 0.218" Wall

1 1/2" IPS
1.625" Outside O.D.
Schedule 40 1.573" I.D. 0.140" Wall
Schedule 80 1.389" I.D. 0.200" Wall

1 1/4" IPS
1.375" Outside O.D.
Schedule 40 1.323" I.D. 0.140" Wall
Schedule 80 1.139" I.D. 0.191" Wall

1" IPS
1.315" Outside O.D.
Schedule 40 1.261" I.D. 0.127" Wall
Schedule 80 1.077" I.D. 0.178" Wall

3/4" IPS
1.062" Outside O.D.
Schedule 40 1.010" I.D. 0.110" Wall
Schedule 80 0.826" I.D. 0.154" Wall