

**07350 Outside Corner Aluminum Magnesium 1-1/4" IPS (1.72" ID)**

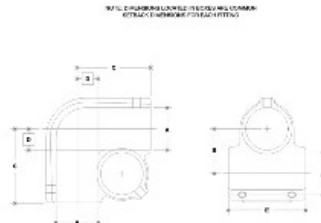

**#20 Outside Corner**

| PIPE SIZE | BASE DIMENSIONS (INCHES) |    |    |    |    |    |    | PIPE SIZE | WITHC DIMENSIONS (INCHES) |    |    |    |    |    |    |
|-----------|--------------------------|----|----|----|----|----|----|-----------|---------------------------|----|----|----|----|----|----|
|           | A                        | B  | C  | D  | E  | F  | G  |           | A                         | B  | C  | D  | E  | F  | G  |
| 1 1/4"    | 33                       | 12 | 12 | 12 | 12 | 12 | 12 | 1 1/4"    | 48                        | 12 | 12 | 12 | 12 | 12 | 12 |
| 1 1/2"    | 48                       | 12 | 12 | 12 | 12 | 12 | 12 | 1 1/2"    | 63                        | 12 | 12 | 12 | 12 | 12 | 12 |
| 2"        | 75                       | 12 | 12 | 12 | 12 | 12 | 12 | 2"        | 90                        | 12 | 12 | 12 | 12 | 12 | 12 |
| 2 1/2"    | 102                      | 12 | 12 | 12 | 12 | 12 | 12 | 2 1/2"    | 117                       | 12 | 12 | 12 | 12 | 12 | 12 |
| 3"        | 129                      | 12 | 12 | 12 | 12 | 12 | 12 | 3"        | 144                       | 12 | 12 | 12 | 12 | 12 | 12 |

[Click here for chart](#)

**BUYRAILINGS**  
EQUIPMENT AND ACCESSORIES

2" IPS  
2.375" Outer O.D.  
Schedule 40 2.381" I.D. 0.146" Wall  
Schedule 80 1.937" I.D. 0.218" Wall

1 1/2" IPS  
1.937" Outer O.D.  
Schedule 40 1.943" I.D. 0.146" Wall  
Schedule 80 1.507" I.D. 0.257" Wall

1" IPS  
1.315" Outer O.D.  
Schedule 40 1.321" I.D. 0.146" Wall  
Schedule 80 0.887" I.D. 0.179" Wall

3/4" IPS  
1.062" Outer O.D.  
Schedule 40 1.068" I.D. 0.147" Wall  
Schedule 80 0.637" I.D. 0.154" Wall