

28360 Offset Support Bracket Aluminum Magnesium 1-1/2" IPS (1.94" ID)

NOTE: DIMENSIONS QUOTED IN INCHES ARE COMMON
DIMENSIONS UNLESS NOTED OTHERWISE

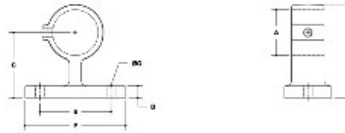

#55 Offset Support Bracket
SCALE: 1:1/2"

PART NO.	LARGE DIAMETER RANGE						MEDIUM DIAMETER RANGE						
	A	B	C	D	E	F	A	B	C	D	E	F	G
55	1.50	4.75	2.75	2.50	1.50	4.57	1.50	4.50	2.50	2.50	1.50	4.50	2.50
55	1.50	4.75	2.75	2.50	1.50	4.57	1.50	4.50	2.50	2.50	1.50	4.50	2.50
55	1.50	4.75	2.75	2.50	1.50	4.57	1.50	4.50	2.50	2.50	1.50	4.50	2.50

- Quick and easy way to assemble structural pipe systems • Galvanized malleable iron
- Reduce labor costs by 70% • 100% reusable • No welding or threading • No drilling or bolting

Strong, malleable iron, slip-on pipe fittings with from one to five case-hardened set screws per fitting – depending on the number of pipes to be joined at one joint.

For slip-on aluminum fittings. These fittings can support an axial load of 2000 lbs per set screw with the set screw tightened to a torque of 29 lbs/ft. This is normally obtained when the screw is fully tightened using a ratchet wrench.