

**00-330/2 Polished Brass Ball End Post 2" OD**

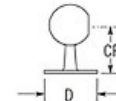

Ball End Post

Item #	Material	Finish	Tube OD	CP	D	Compatible Tubing OD
00-330/1	Brass	Polished	1"	2 $\frac{3}{4}$ "	2 $\frac{1}{4}$ "	00-A100
00-330/1H	Brass	Polished	1 $\frac{1}{2}$ "	2 $\frac{3}{4}$ "	2 $\frac{5}{8}$ "	00-A110
00-330/2	Brass	Polished	2"	3"	3 $\frac{1}{4}$ "	00-A120

Architectural hardware provides a unique breadth of decorative hardware brackets for mounting metal railings in all kinds of settings. And, like your handrail, footrail, stair railing, kitchen rail system or other railing, brackets may be available in a variety of finishes in addition to traditional brass fittings, including white, stainless steel, and more. All brackets and are supplied with necessary hardware for proper installation.

**Note:**

Fittings are supplied with self-drilling, self-tapping hardware.

Mount brackets to stud in wall.

Maximum spacing between brackets is 4 feet.

Consult local codes for rail height and other requirements.