

PART# 308U/1H

Undrilled Handrail Bracket for 1-1/2" Diameter Tubing

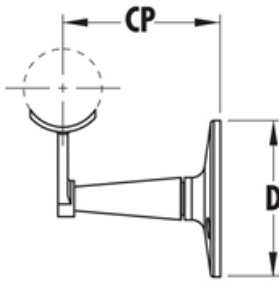

CP	3-1/16"
D	3

MATERIAL & AVAILABLE FINISHES			
	BRASS	304 SST	316 SST
Polished			
Satin			√
Clear Coat			

MATERIAL USAGE			
	BRASS	304 SST	316 SST
Indoor			√
Outdoor			√

*Uncoated brass only

MATERIAL CARE	
Stainless Steel	Use metal cleaner and apply with a damp, soft cloth.

INSTALLATION	Mount plate to the wall and matching diameter tube to the saddle. Thread on back of stem is 5/16"-18 x 1" deep.
HARDWARE INCLUDED	2 x #8 x 5/8" Philips flat head self drilling screws.
USE TOGETHER WITH	1.5" OD tube (A110), matching flush fittings for 1.5" tube (730/1H series) and matching finials (600/1H, 602/1H, 608/1H).