

08860 Universal Adapter in Aluminum Magnesium Pipe Size-1-1/2" IPS

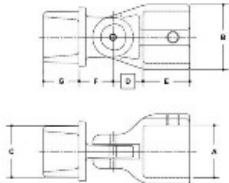

NOTE: DIMENSIONS LOCATED IN BORES ARE COMMON
DIMENSIONS (BRANCHES) FOR BRANCH FITTING



#24 Universal Adapter

SCALE: 1/2"=1'

DIMENSIONS (IPS) (mm)								DIMENSIONS (IPS) (mm)							
PIPE SIZE	A	B	C	D	E	F	G	PIPE SIZE	A	B	C	D	E	F	G
2"								2"	40	41	48	58	64	52	53
1 1/2"	1.58	2.41	1.58	1.11	1.55	1.08	1.51	1 1/2"							
1"								1"							
3/4"								3/4"							

Used to connect a 1-1/2" IPS fitting to a pipe.

One side (dimension A) fits over pipe.

The other side (dimension C) fits into a fitting.