

58016 Anodized Aluminum Pipe Size-1-1/2" IPS Elbow

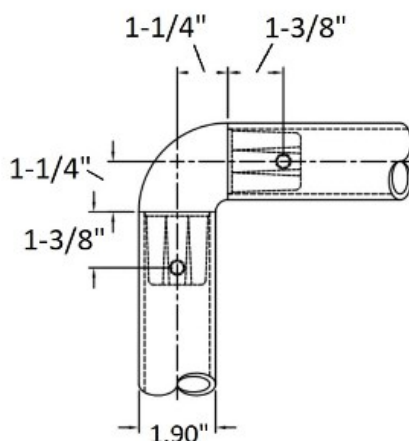

Interna-Rail® item# 58016 is a cast aluminum 90 degree elbow with an anodized finish and is designed to connect with 1-1/2" IPS schedule 40 pipe. This item includes two set screws that are used to connect the pipe to the fitting.

To connect the pipe to the fitting drill a 27/64" diameter hole with the center of the hole located at 1-3/8" from the end of the pipe. The hole will line up with the set screw hole on the fitting. Insert and tighten the set screw until the pipe is fixed to the fitting.