

00-821/2 Ball Adjustable Saddle for 2" OD Tube in Polished Brass

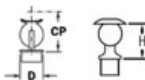

Adjustable Ball Saddle

Used to connect a vertical post to a horizontal tube at an angle.

Item #	Material	Finish	Tube OD	Wall Thick	D	CP	H	Compatible Tubing OD
40-821/1H	SS 304	Polished	1 1/2"	0.05"	1 1/2"	3 3/4"		40-A110
44-821/1H	SS 304	Satin	1 1/2"	0.05"	1 1/2"	3 3/4"		44-A110
49-821/424	SS 316	Satin	1.67"	0.08"			2.5"	49-A114
00-821/2	Brass	Polished	2"	0.05"	2"	2 3/4"		00-A120
40-821/2	SS 304	Polished	2"	0.05"	2"	2 3/4"		40-A120
40-821/2	SS 304	Polished	2"	0.05"	2"	2 3/4"		40-A120

Universal railing connectors are either factory assembled into metal posts or as individual components to accommodate any handrail, foot rail, stair railing, or other architectural railing configuration. Available finishes may include polished brass, satin, chrome plated, or Lido-Tone powder coating.